



FAIRMONT MEDICAL RESPITE RECUPERATIVE CARE CENTER

PROGRAM FACT SHEET



OVERVIEW

The Fairmont Navigation Center, located in the unincorporated area of Alameda County, serves to help people experiencing homelessness achieve stability, self-sufficiency, and transition into permanent housing. The site provides housing navigation services and supports connections to medical care, substance use treatment and counseling for participants in a safe and low-barrier environment.

The innovative Fairmont Medical Respite Recuperative Care site opened its doors on the Fairmont Campus in August 2021. The site is comprised of 34 beautiful, modern non-congregate units; 28 standalone units and one modular building with six individual units. Each unit offers central heating and cooling, a kitchen, shower, and living and sleeping area. Individuals-served can access laundry and a program office at the main Fairmont Navigation Center site via gently winding pathways.

The site provides individuals experiencing unsheltered homelessness with respite services to recover from an injury or illness including interim housing and a path toward permanent housing. The site provides housing navigation services and supports connections to medical care, substance use treatment and counseling for participants in a safe and low-barrier environment.

Individuals from Mid-County (prioritizing those from the unincorporated area) that have experienced long periods of homelessness and who are considered highly vulnerable will be prioritized.

The Fairmont Medical Respite Recuperative Care Center is operated by Five Keys Schools and Programs, a local nonprofit commitment to serving homeless and at-risk populations.

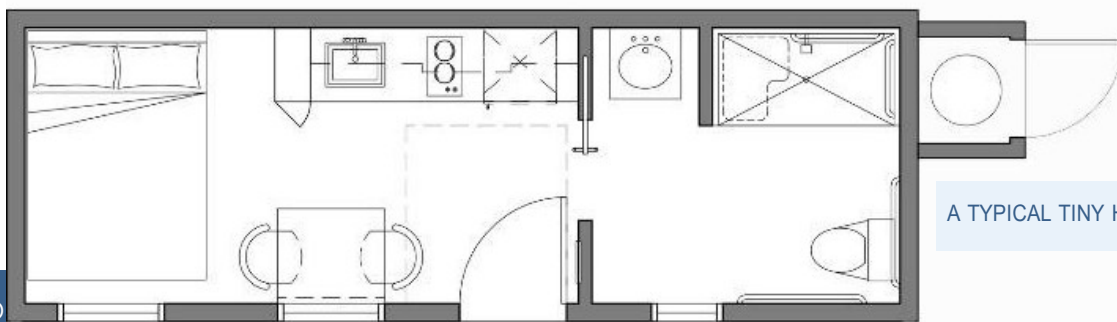

A TYPICAL TINY HOME LAYOUT

END

PROGRAM DETAILS

- The Fairmont Medical Respite Recuperative Care will serve 34 individuals at a time and anticipates serving 100 annually, with an average length of stay of three months.
- Provides medical care to prevent hospitals and stabilize health to increasing aging and complex unsheltered homeless population.
- Focus on transitions to secure, long-term, permanent, and stable housing.

Individuals-served will have access to dedicated staff working to connect participants with services including:

- Nursing and Care Giver Services
- One-on-one intensive housing navigation case management, Linkages to other needed services such as health and wellness, job training, employment, and behavioral health support.
- Provision of onsite meals
- Provision of 24/7 staffing and onsite security.

The Medical Respite Recuperative Care Model has proven to be successful and cost effective

HOMELESSNESS IN ALAMEDA COUNTY

Based on the 2019 Point in Time Count, more than 8,000 people experience homelessness in Alameda County each night, with 79% of this population experiencing unsheltered homelessness - on the street, in tents, or in vehicles. This demonstrates double the number of individuals who experienced homelessness in Alameda County in 2015. 2019 data reflects that for each person exiting homelessness in our County, three more become homeless. Skyrocketing rents over the last decade in the County have contributed to homelessness, as roughly 80% of those who are currently experiencing homelessness in Alameda County lived here before losing their home.

PROJECT FUNDING & COSTS

Fairmont Medical Respite Site is supported by State and Federal funding sources for COVID-19 responses and AC Homelessness Capital Projects Fund Designation approved by the Alameda County Board of Supervisors.



Alameda County
Health Care Services Agency

